

SERIES 700

SHAW-BOX 700 Series wire rope hoists are designed and manufactured for heavy-duty service. This workhorse is built to deliver, day-in and day-out, under tough operating conditions. 700 Series hoists are built to take even the most demanding job cycles in stride, yet can be relied upon to handle your most delicate loads with precision control.

Their compact design, with high hook lift and closer end approaches, maximizes hook coverage within an existing facility, reducing or eliminating the need for costly rebuilding or remodeling. 700 Series hoists achieve an unusually high hook lift, without resorting to design compromises.

This line offers the greatest range of lifting speeds, controls, headroom and mounting options of any hoists on the market today. 700 Series hoists are available in both electric and air powered models. Options include standard and low headroom, deck and base mounted models, with a choice of single reeving or true vertical lift. The lug is integral with the all-steel, one-piece welded

frame, and is designed for station overhead structure or with any of

FEATURES

- 1 One-piece welded steel frame ensures hoisting machinery life
- 2 Alloy aluminum gear case and cover is lightweight yet rugged
- 3 Direct acting D.C. brake solenoid for smooth braking action
- 4 Multiple disc motor brake for long life and maximum braking efficiency
- 5 Bearings supported in an independent gear case spider give a precise fit, and allow removal of the gear case cover without disassembly of the gearing
- 6 Hinged control panel cover permits easy access to the control components
- 7 Improved plow steel preformed wire rope for maximum strength and life
- 8 Full-swiveling, heat-treated forged steel hook with spring loaded latch
- 9 Shrouded lower block to help prevent pinched fingers
- 10 Push-button control pendant for easy one-handed operation
- 11 Rugged, low-maintenance magnetic contactor control
- 12 High torque, heavy-duty hoist motor for smooth load handling
- 13 Watershed and gaskets for tight frame cover seal and protection of internal components
- 14 Integrally welded mounting lug permits various trolley attachment options
- 15 Block operated limit switch limits upward hook travel
- 16 Rope anchor, easily accessible for inspection and maintenance
- 17 Deep grooved, large diameter rope drum helps prevent rope overwrap for longer rope life
- 18 Double reduction helical gearing provides a smooth, quiet drive train
- 19 Positive action mechanical load lowering control brake, also acts as a part of the hoist holding brake system



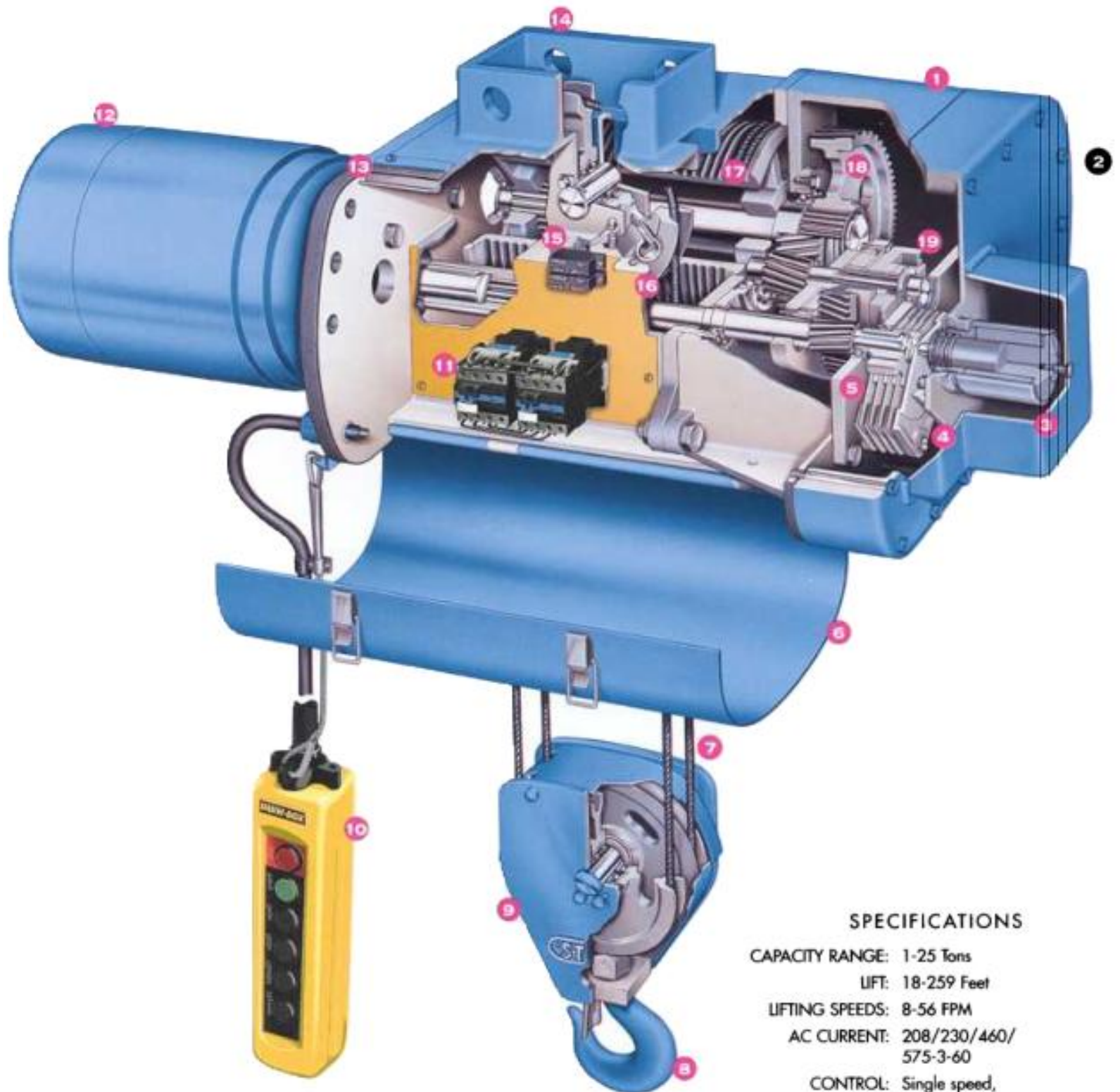

SPECIFICATIONS

- CAPACITY RANGE: 1-25 Tons
- LIFT: 18-259 Feet
- LIFTING SPEEDS: 8-56 FPM
- AC CURRENT: 208/230/460/
575-3-60
- CONTROL: Single speed,
Two speed,
Variable Frequency Control
- SUSPENSION: Lug, Push Trolley,
Hand Geared Trolley,
Motor Driven Trolley,
Deck and Base

SERIES 700/800 STANDARD FEATURES

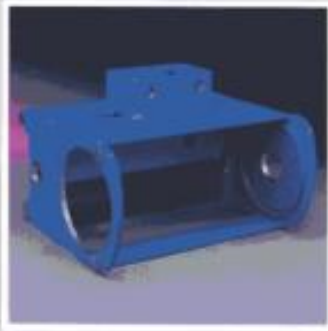

Welded Steel Frame

One-piece welded frame, fabricated from rolled steel sections, precision machined for long life and accurate bearing and components alignment. (700 Series frame illustrated)



Automatic Load Brake

Weston self-adjusting type, operates in the oil bath of the hoist gear case for smooth lowering control. Capable of holding the load independent of the hoist motor brake. (700 Series load brake illustrated)



Lug Suspension

Permits the hoist to be mounted in a permanent location. (Mounting hardware not included)

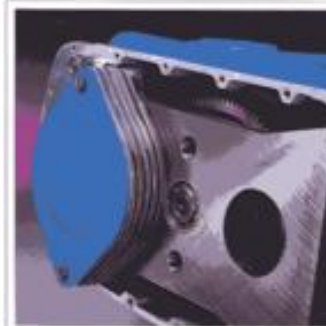

Hoist Motor Brake

Short stroke, 150% torque spring-set D.C. rectified disc type brake provides quiet operation and long life. (700 Series multiple disc brake illustrated)



Precision Machined Gearing

For uniform tooth mesh and large contact surface. Operates in a totally enclosed, oil bath lubricated gear case. Gear trains consist of two or three reductions, using helical and/or spur gearing.



Machined Rope Drum

Large diameter, welded construction — deep grooved and precision machined to give maximum rope life. Pictured is a right and left hand grooved true vertical lift drum.



Dead End Rope Anchor

Used on single reeved hoists. Easily accessible and part of the one-piece welded frame, it securely anchors the rope compression shimble fitting which is swaged to the rope ends. True vertical lift hoists have both ends of the steel rope dead ended to the rope drum.

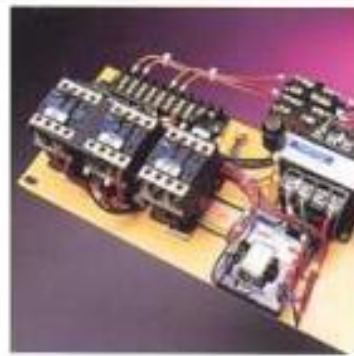

Heavy-Duty Controls

Designed for a clean, open layout to maximize performance and ease of maintenance. Contactors are oversized for increased life. Panels are housed in a dust resistant compartment designed for easy access and serviceability. (700 Series hoist control illustrated)



Shrouded Lower Block

Helps prevent fingers from being pinched between rope and sheaves and prevents dirt buildup. All hooks are provided with spring loaded safety latches.



Hoist Motors

High starting torque type, designed specifically for hoisting, with permanently lubricated ball bearings. Motors are totally enclosed, non-ventilated (T.E.N.V.) with class F insulation, and provided with an automatic reset, temperature actuated switch in the windings to provide over current protection.

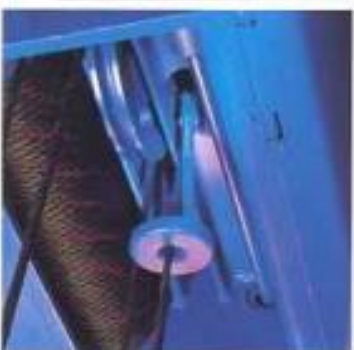

Block Operated Limit Switch

For additional protection of operator, hoist, and load. Positive acting, momentarily reverses the hoisting motion if lower block drifts too high. (700 Series block limit switch illustrated)



Convenient Push-Button Control

All motions can be controlled from a convenient, easy to operate push-button control station suspended from the hoist. An external strain reliever cable extends cable life and prevents pulling the control cable from the hoist electrical connection on four button and larger stations.

SERIES 700/800 OPTIONAL FEATURES



Push Trolley Suspension

Push trolleys are used for mounting hoists on monorails or single girder crane bridges. Operator can quickly move loads by pushing on the load.



Deck Mounted Hoists

Used for applications that require a stationary hoist, or for construction of a top-running trolley.



Hand Geared Trolley Suspension

For moving loads where accurate spotting is essential or when operator should not touch the load.



Top Running Double Girder Trolleys

Provides a combination of lower headroom, higher hook lift, and closer end approaches. Maximizes hook coverage within existing facility, without costly remodeling or rebuilding.



Motor Driven Trolley Suspension

Used for moving loads quickly over long distances and where accurate load spotting is needed. Control push buttons can be suspended from hoist or crane bridge.



Air Operated Hoists

Air operation is available for all SHAW-BOX hoists where precise spotting or slow hoisting speeds are required, or where an electrically powered hoist may not be suitable. (Illustrated is an air-piston motor driven 700 Series hoist)